

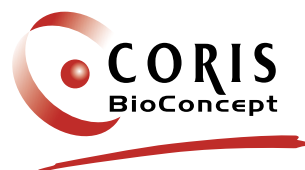

Rapid testing for Antimicrobial resistance markers and infectious diseases



Innovative solutions for effective diagnostics

www.corisbio.com



Company Profile

Coris BioConcept is a leading expert of rapid *in vitro* diagnostics of human infectious diseases since 1996. Based in Belgium, the company develops, produces and markets IVD kits for respiratory, gastro-enteric and blood-borne pathogens (bacteria, viruses and parasites) as well as serological assays, mainly based on the immunochromatographic technology (ICT).

Anti-Microbial Resistance concern pushed Coris BioConcept to develop a range of assays (RESIST) for rapid detection of antibiotic resistance mechanisms. Aside from this range, another innovative approach for 3GC detection was recently launched with a front line test: BL-RED.

This R&D expertise is ideally suited for “on demand” production of innovative solutions in a rapidly changing world that calls for cutting edge biotechnology to take us forward into a healthy future.

All **Coris BioConcept’s** assays fulfil the CE marking requirements with an ISO 13485 certification and they are used in over 60 countries all over the world.

Coris BioConcept is now part of Avacta Group.

Discover our company and more information on www.corisbio.com



Follow us on
LinkedIn

AMR range

Electrochemical range

Detection test of resistance to third-generation cephalosporins by hydrolysis

| PRODUCT NAME | DESCRIPTION | CODE |
|--------------|---|----------|
| BL-RED 25 | 25 RED-Sensors, BL-Reagent, TPTZ-Buffer, BCL-Buffer | RED-0001 |

Immunochematographic Tests

Detection of the major cephalosporinases and carbapenemases (RESIST)

| TARGET | PRODUCT NAME | DESCRIPTION | CODE |
|--------------------------------|-----------------------|---|---------|
| OXA-48 | OXA-48 K-SeT | 20 cassettes, buffer, 20 tube-droppers | K-15R1 |
| OXA-48 & OXA-163 & KPC | RESIST-3 O.O.K. K-SeT | 20 cassettes, buffer, 20 tube-droppers | K-15R4 |
| OXA-48 & KPC & NDM | RESIST-3 O.K.N. K-SeT | 20 cassettes, buffer, 20 tubes and pipettes | K-15R5 |
| OXA-23 | OXA-23 K-SeT | 20 cassettes, buffer, 20 tubes-droppers | K-15R7 |
| OXA-48 & KPC & NDM & VIM & IMP | O.K.N.V.I. RESIST-5 | 2x20 cassettes, buffer, 20 tubes and pipettes | K-15R11 |
| OXA-23 & OXA-40 & OXA-58 & NDM | RESIST ACINETO | 20 cassettes, buffer, 20 tubes and pipettes | K-15R13 |
| Group 1 & Group 8 & Group 9 | RESIST CTX-M | 20 cassettes, buffer, 20 tubes and pipettes | K-15R14 |

2024

NEW

ADDITIONAL MATERIAL TO ACCELERATE RESIST RANGE RESULTS

| PRODUCT NAME | DESCRIPTION | CODE |
|--------------|---|--------|
| RESIST-BC | Reagents kit for blood culture 1 RBCL solution, 1 MS buffer, 1 Washing buffer | S-1001 |
| ReSCape | Culture reagents kit on rectal swab 20 CProBE MEDIUM tubes, 2 Selective Mix vials, 2 Water vials | S-1002 |

CONTROLS AND ANTIGENS RANGE

| PRODUCT NAME | ANTIGEN | PACKAGING | CODE |
|--|----------------------------|--------------|-----------|
| RESIST penta O.K.N.V.I control (5 vials of individual controls) | OXA-48, KPC, NDM, VIM, IMP | Freeze-dried | P-10R11 |
| OXA-163 Positive Control | OXA-163 | Freeze-dried | P-10R4-1 |
| OXA-23 Positive Control | OXA-23 | Freeze-dried | P-10R7 |
| CTX-M-14 Antigens* | CTX-M-14 | Freeze-dried | P-10R14-1 |
| CTX-M-15 Antigens* | CTX-M-15 | Freeze-dried | P-10R14-2 |
| OXA-40 Antigens* | OXA-40 | Freeze-dried | P-10R13-1 |
| OXA-58 Antigens* | OXA-58 | Freeze-dried | P-10R13-2 |

2024

NEW

* : Not CE-marked

Respiratory range

LAMP range

Detection of viral RNA

| PRODUCT NAME | DESCRIPTION | CODE |
|-----------------------|--|--------|
| SARS-CoV-2 RT-LAMP | RT-LAMP Mastermix, LAMP Additive, SARS-CoV-2 primers, SARS-CoV-2 RNA Control | L-0001 |
| FLU A & FLU B RT-LAMP | RT-LAMP Mastermix, LAMP Additive, FLU A Primers, FLU B Primers, FLU A RNA Control, FLU B RNA Control | L-0002 |

Immunochromatographic Tests

| PATHOGEN | PRODUCT NAME | DESCRIPTION | CODE |
|-------------------------------|---------------------------------------|---|--------|
| Respiratory Syncytial Virus | RSV Respi-Strip | 25 strips, buffer | C-1006 |
| | RSV K-SeT | 20 cassettes, buffer | K-1206 |
| | RSV K-SeT with collection set | 20 cassettes, buffer, 20 swabs 20 tube-droppers | K-1506 |
| Respiratory Adenovirus | Adeno Respi-Strip | 25 strips, buffer | C-1009 |
| | Adeno Respi K-SeT | 20 cassettes, buffer | K-1209 |
| | Adeno Respi K-SeT with collection set | 20 cassettes, buffers, 20 swabs 20 tube-droppers | K-1509 |
| Influenza A & B Viruses | Influ A+B K-SeT | 20 cassettes, buffer | K-1212 |
| | Influ A+B K-SeT with collection set | 20 cassettes, buffer, 20 swabs, 20 tube-droppers | K-1512 |
| <i>Legionella pneumophila</i> | Legionella K-SeT | 20 cassettes, 20 transfer pipettes | K-1215 |
| | Legionella K-SeT with controls | 20 cassettes, 20 transfer pipettes, positive and negative controls | K-1515 |
| SARS-CoV-2 | COVID-19 Ag K-SeT** | 20 cassettes, 20 tubes with buffer, 20 droppers, 20 swabs | K-1525 |

CONTROLS AND ANTIGENS RANGE

| PRODUCT NAME | ANTIGEN | PACKAGING | CODE |
|------------------------------|-------------------------------|--------------|----------|
| Adenovirus Positive Control | Adenovirus type 40 | Freeze-dried | P-1002 |
| RSV Positive Control | RSV | Freeze-dried | P-1006 |
| Legionella Positive Control | <i>L. pneumophila</i> extract | Liquid | P-1015 |
| COVID-19 Ag Positive Control | Nucleoprotein | Freeze-dried | P-1023 |
| Negative Control | <i>S. pyogenes</i> extract | Liquid | CTR-1000 |
| Influ A Antigens* | Nucleoprotein | Freeze-dried | P-1012-1 |
| Influ B Antigens* | Nucleoprotein | Freeze-dried | P-1012-2 |

2024

NEW

* : Not CE-marked

** : On Demand

Gastro-enteric range

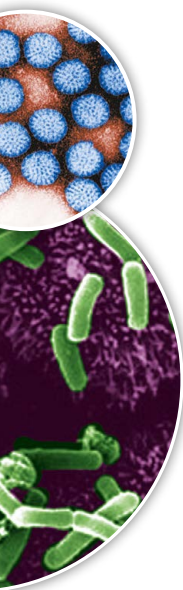

| PATHOGEN | PRODUCT NAME | DESCRIPTION | CODE |
|--------------------------------------|---------------------------------------|--|-------------|
| <i>Helicobacter pylori</i> | Pylori-Strip | 25 strips, buffer | C-1019 |
| | Pylori K-SeT with collection set | 20 cassettes, 20 faecal sampling systems | K-1519 |
| PATHOGEN | PRODUCT NAME | DESCRIPTION | CODE |
| Rotavirus | Rota-Strip | 25 strips, buffer | C-1001 |
| Rotavirus & Adenovirus | Combi-Strip | 25 strips, buffer | C-1004 |
| | Combi K-SeT | 20 cassettes, buffer | K-1204 |
| | Combi K-SeT with collection set | 20 cassettes, 20 faecal sampling systems | K-1504 |
| <i>Giardia</i> | Giardia-Strip | 25 strips, buffer | C-1013 |
| | Giardia K-SeT with collection set | 20 cassettes, 20 faecal sampling systems | K-1513 |
| Rotavirus & Adenovirus 40/41 | Gastro Vir K-SeT with collection set | 20 cassettes, 20 faecal sampling systems | K-1516 |
| <i>Cryptosporidium & Giardia</i> | Crypto/Giardia Duo-Strip | 25 strips, buffer | C-1018 |
| <i>Clostridium difficile</i> | Clostridium K-SeT | 20 cassettes, buffer | K-1220 |
| | Clostridium K-SeT with collection set | 20 cassettes, 20 faecal sampling systems | K-1520 |

CONTROLS RANGE

| PRODUCT NAME | ANTIGEN | PACKAGING | CODE |
|------------------------------|------------------------------|------------------|-------------|
| Rotavirus Positive Control | Rotavirus | Freeze-dried | P-1001 |
| Adenovirus Positive Control | Adenovirus type 40 | Freeze-dried | P-1002 |
| Giardia Positive Control | Giardia specific antigen | Liquid | P-1013 |
| Pylori Positive Control | H. pylori specific antigen | Liquid | P-1019 |
| C difficile Positive Control | GDH from <i>C. difficile</i> | Freeze-dried | P-1020 |
| Negative Control | <i>S. pyogenes</i> extract | Liquid | CTR-1000 |

Tropical range



| DRUG | PRODUCT NAME | DESCRIPTION | CODE |
|-------------|---------------------|--------------------|-------------|
| Proguanil | Proguanil-Strip** | 20 strips | C-10T1 |
| Mefloquine | Mefloquine-Strip** | 20 strips | C-10T2 |



| PATHOGEN | PRODUCT NAME | DESCRIPTION | CODE |
|-------------------------------|--------------------------------------|---|-------------|
| Human African Trypanosomiasis | HAT Sero K-SeT** | 40 cassettes, buffer, capillary tubes | K-12S2 |
| | HAT Sero K-SeT with collection set** | 40 cassettes, buffer, capillary tubes, blood lancets, alcohol prep pads | K-15S2 |

** : On Demand



Strip Test

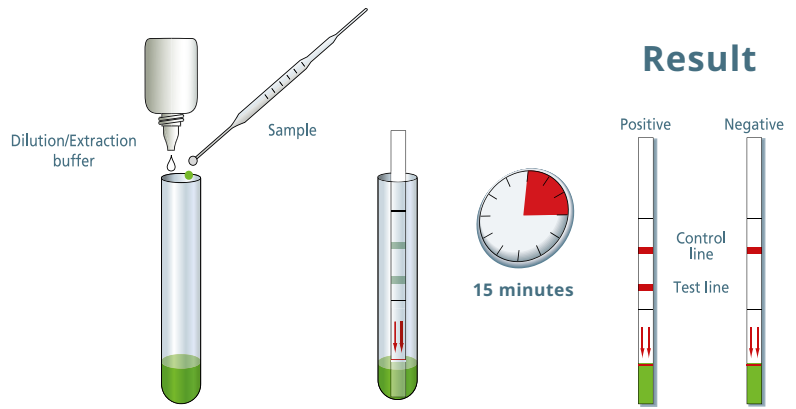

K-Set

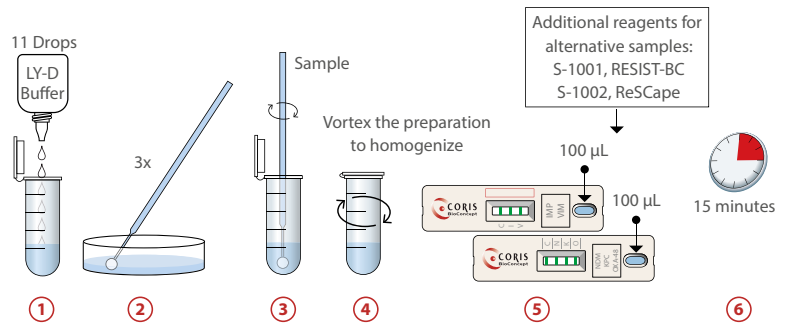
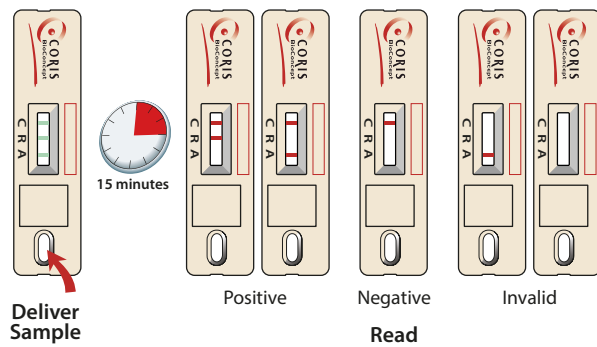

Controls

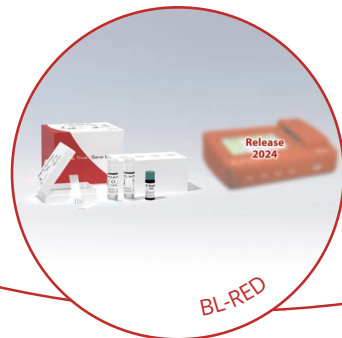

BL-RED

— Distributed by —



CREALYS Science Park
 Rue Guillaume Fouquet 11
 5032 Gembloux - BELGIUM
 T +32 (0)81 719 910 - F +32 (0)81 719 919
 sales@corisbio.com - www.corisbio.com



D-CUS-10-PC/22
 April 2024

MADE IN BELGIUM